

Welding process:
MIG/MAG, GMAW, 131,135
Technical data according to IEC60974-7



Gas



300 A - CO2 100%



250 A - Mix M21 (ISO 14175) 100%



Ø1.0-1.2 mm



10-18 l/min

The capacity will be reduced by 35% whit pulsed arc.

Line of COBOT torches adapts perfectly to all the requirements of collaborative robots due to its low weight and functionality.

Robust and light necks calibrated to maintain a stable TCP during the life of the torch, in addition to stainless steel structure that gives an excellent rigidity and avoids the increase of the temperature in the back areas of the neck, being able to be handled with greater ease, but always maintaining the precautions that a welding process requires.

STANDARD CONFIGURATION

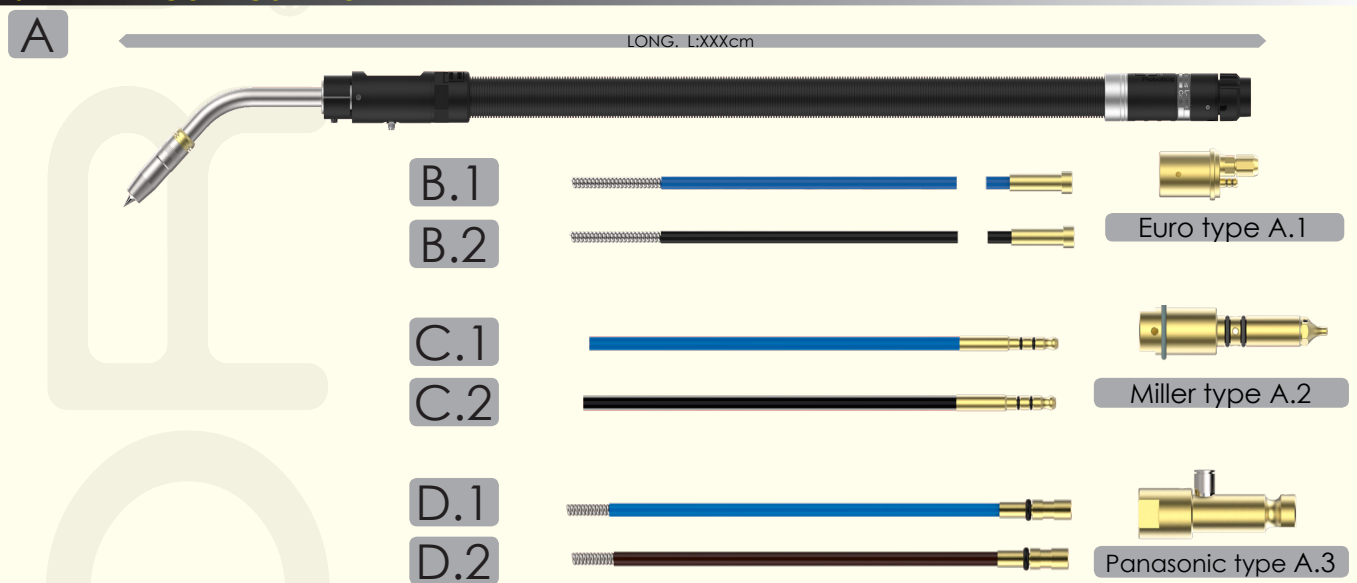

Pos.	TYPE	CODE	Min. Q.
A.1	Welding torch 42G-22° gas eBASIC-Euro type	R98 1xxx 22	1
	Welding torch 42G-45° gas eBASIC-Euro type	R98 1xxx 45	1
A.2	Welding torch 42G-22° gas eBASIC-Miller type	R98 2xxx 22	1
	Welding torch 42G-45° gas eBASIC-Miller type	R98 2xxx 45	1
A.3	Welding torch 42G-22° gas eBASIC-Panasonic type	R98 3xxx 22	1
	Welding torch 42G-45° gas eBASIC-Panasonic type	R98 3xxx 45	1
B.1	Guide blue L2600xØ4.6xØ1.5mm (0.8-1.0mm)-Euro	M99SR02B	1
	Guide blue L3600xØ4.6xØ1.5mm (0.8-1.0mm)-Euro	M99SR03B	1
B.2	Guide black L2600xØ5.3xØ2.2mm (1.2-1.6mm)-Euro-HD	M99 4002	1
	Guide black L3600xØ5.3xØ2.2mm (1.2-1.6mm)-Euro-HD	M99 4003	1
C.1	Guide blue L2600xØ4.6xØ1.5mm (0.8-1.0mm)-Miller type	M99 1002	1
	Guide blue L3600xØ4.6xØ1.5mm (0.8-1.0mm)-Miller type	M99 1003	1
C.2	Guide black L2600xØ5.3xØ2.2mm (1.2-1.6mm)-Miller type	M99 1102	1
	Guide black L3600xØ5.3xØ2.2mm (1.2-1.6mm)-Miller type	M99 1103	1
D.1	Guide blue L2600xØ4.6xØ1.5mm (0.8-1.0mm)-Panasonic type	M99 1302	1
	Guide blue L3600xØ4.6xØ1.5mm (0.8-1.0mm)-Panasonic type	M99 1303	1
D.2	Guide black L2600xØ5.3xØ2.2mm (1.2-1.6mm)-Panasonic type	M99 1202	1
	Guide black L3600xØ5.3xØ2.2mm (1.2-1.6mm)-Panasonic type	M99 1203	1

© 2019 EDRTorches, S.L. All rights reserved. Subject to change without notice. Excerpts and reprints not permitted.

enDS-42G-01



SPARE PARTS

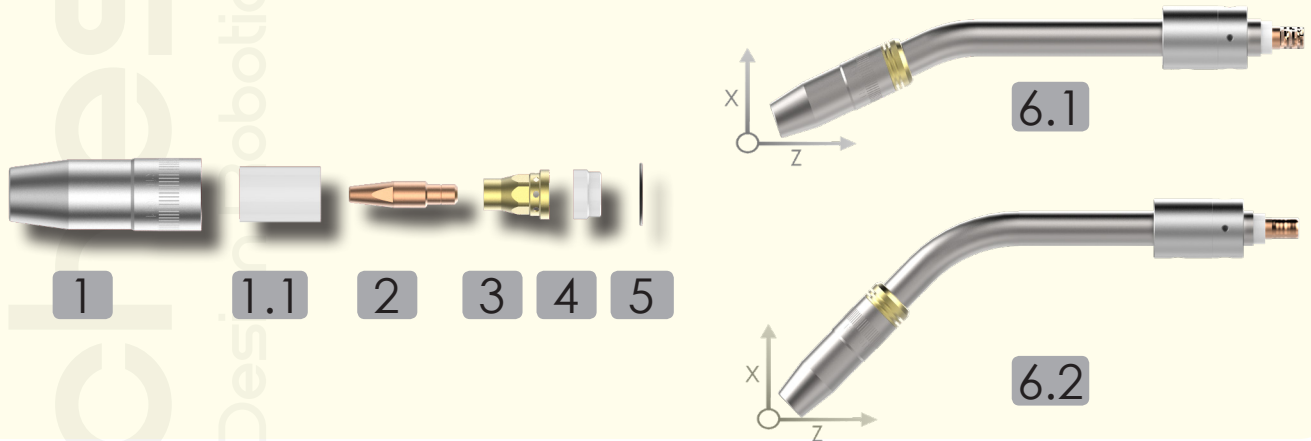

Pos.	TYPE	CODE	Min. Q.
1	Nozzle L76xØ15.5 mm	R10 0011	2
	Nozzle L76xØ13 mm	R10 0012	2
	Nozzle L79xØ15.5 mm	R10 00211	2
1.1	Insulator nozzle L35XØ19.5 mm	R10 0002	2
2	Contact tip M10 1.0 mm Cu-BICOMP	R10 0400 10	5
	Contact tip M10 1.2 mm Cu-BICOMP	R10 0400 12	5
	Contact tip M10 1.0 mm CuCrZr	R10 0401 10	5
	Contact tip M10 1.2 mm CuCrZr	R10 0401 12	5
3	Diffuser L26xØ18.5 mm M10	R12 0013	2
4	Insulator neck L11XØ18.5 mm	R12 0308	2
5	O-ring neck Ø23 mm	R10 0401	10
6.1	Torch neck BASIC-42G 22° (X=50 mm, Z=263 mm)	R11 4220	1
6.2	Torch neck BASIC-42G 45° (X=111 mm, Z=227 mm)	R11 4450	1

ACCESSORIES

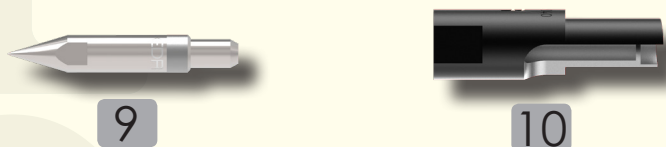

Pos.	TYPE	CODE	Min. Q.
9	Tip TCP M10-15mm programming	R10 0115	1
10	Clining reamer TH L26xØ15x10.5mm	R03 2040	1

STANDARD MEASURES

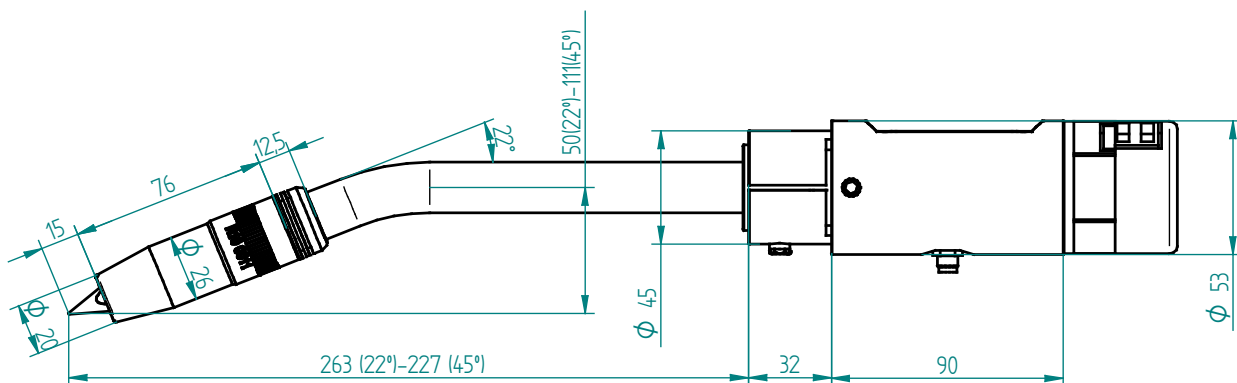

© 2019 EDRtorches, S.L. All rights reserved. Subject to change without notice. Excerpts and reprints not permitted.